

"DOCCE FLAT D" mod. XC1 - Con profili esterni per installazioni su qualsiasi tipo di piatto esistente oppure su pavimento finito / With external profiles for installation on finished floor or any type of shower tray

Soluzioni ad angolo - corner solution

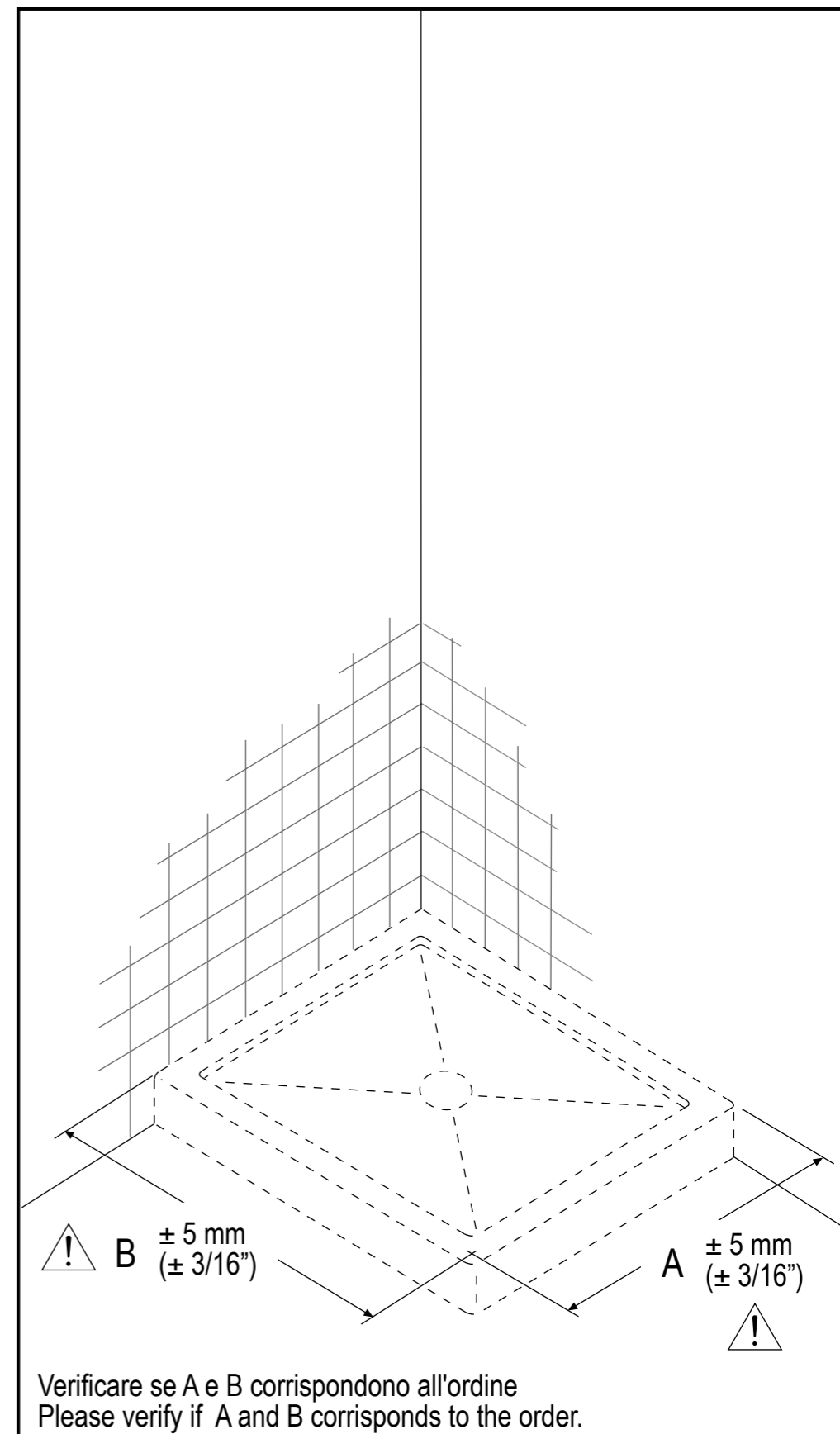

Strumenti /  
Instruments

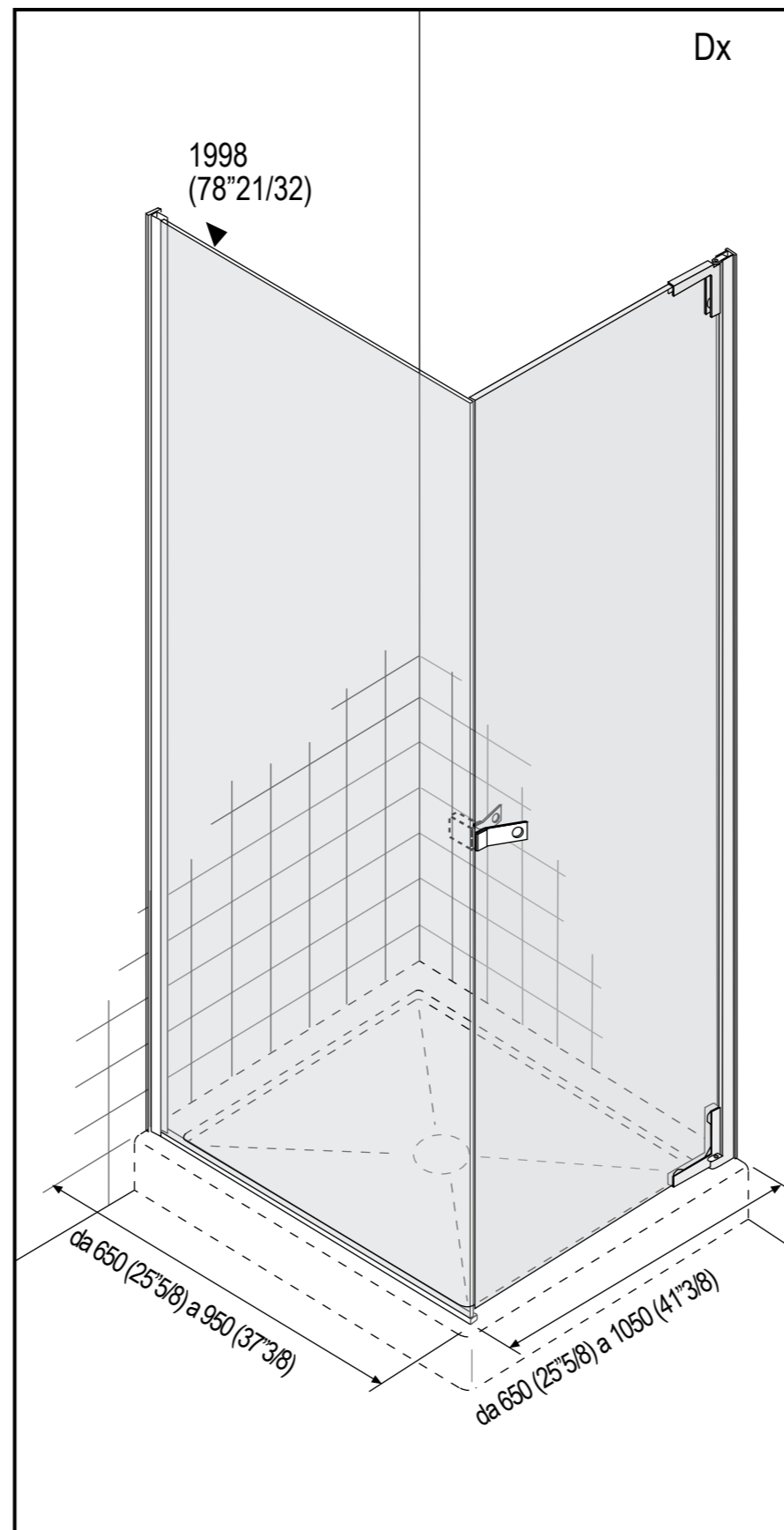
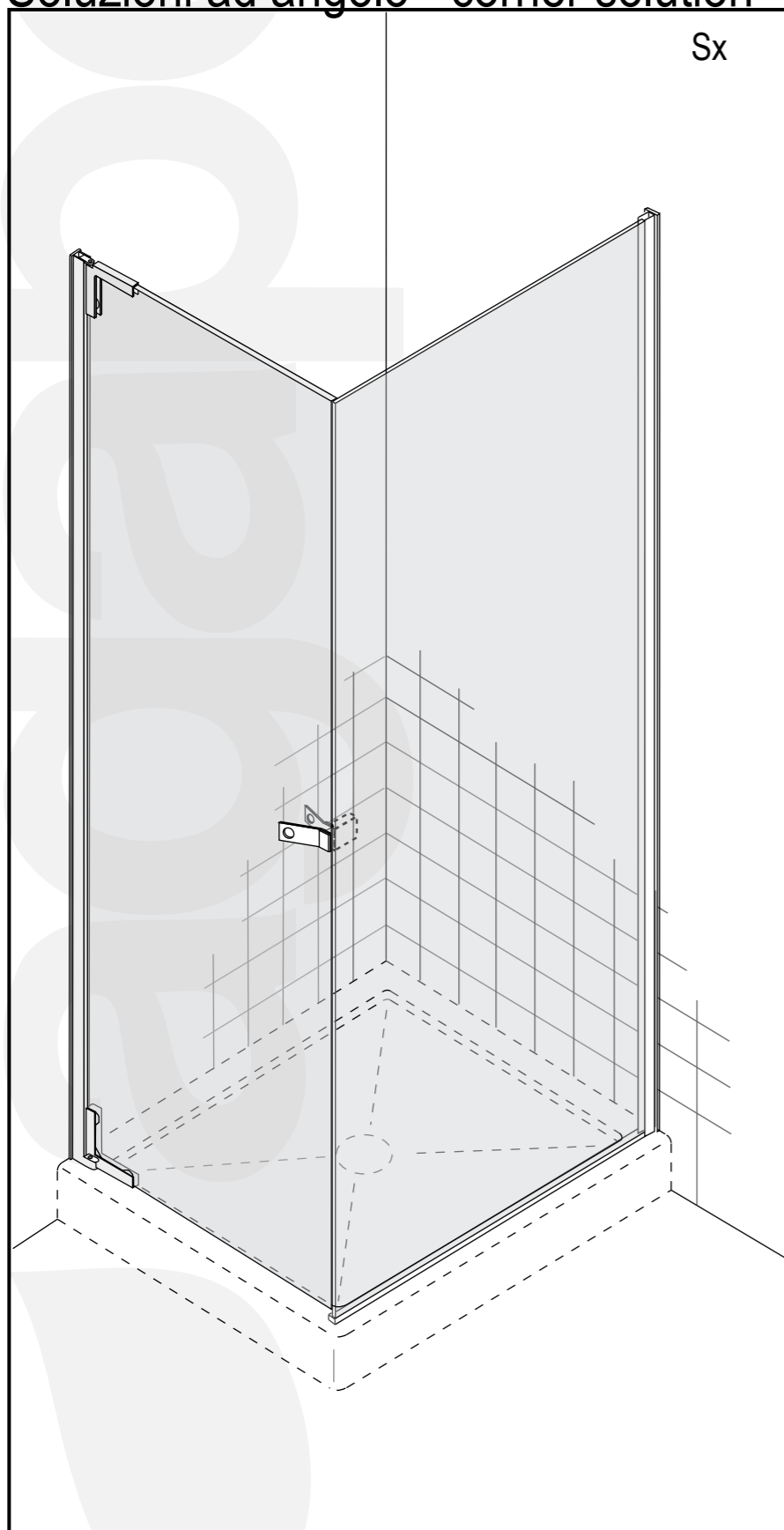
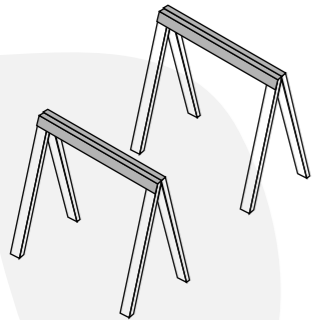
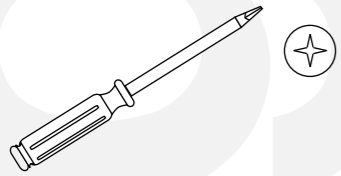
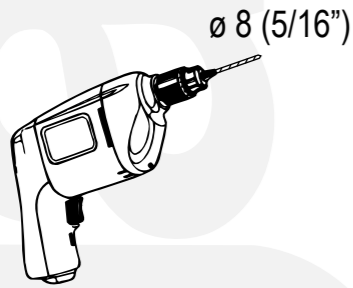
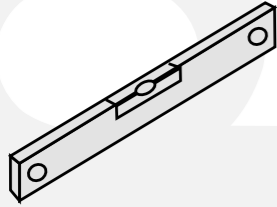

Fianco / side panel - Esploso / pre - assembled



(a) n°1



(b) n°1

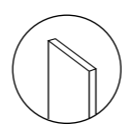

(c) n°1



(d) n°2



(e) n°3

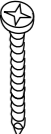

(f) n°3



(g) n°2

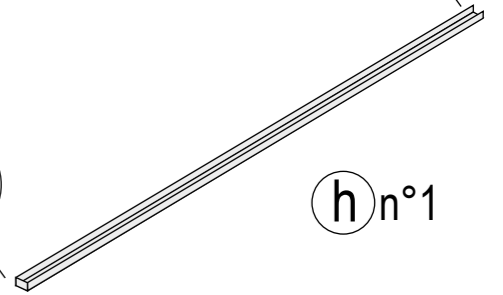
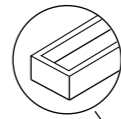

(h) n°1

\* Attenzione: contiene una calamita.  
Please note: contains a magnet.

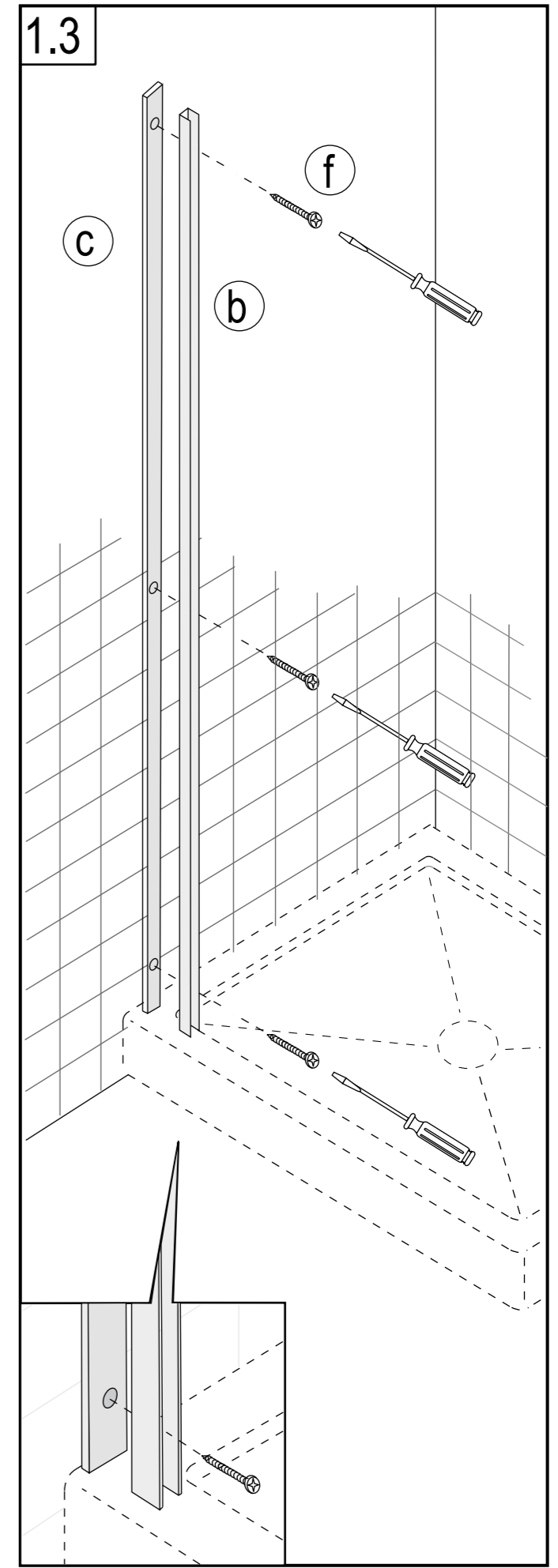
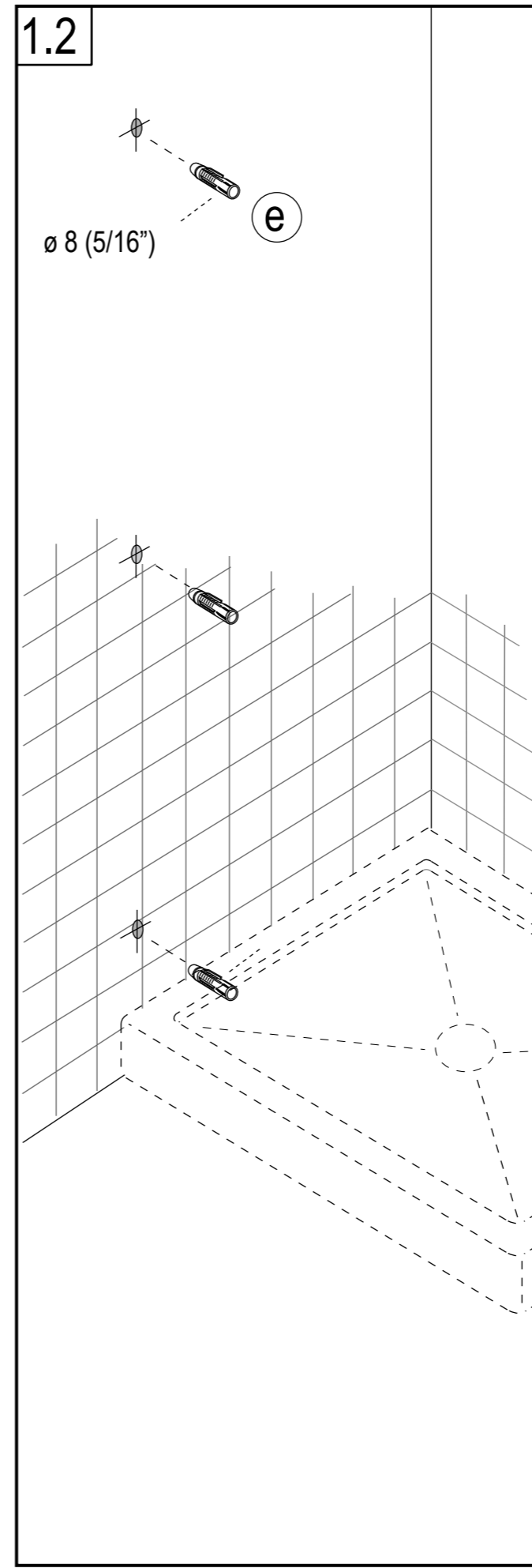
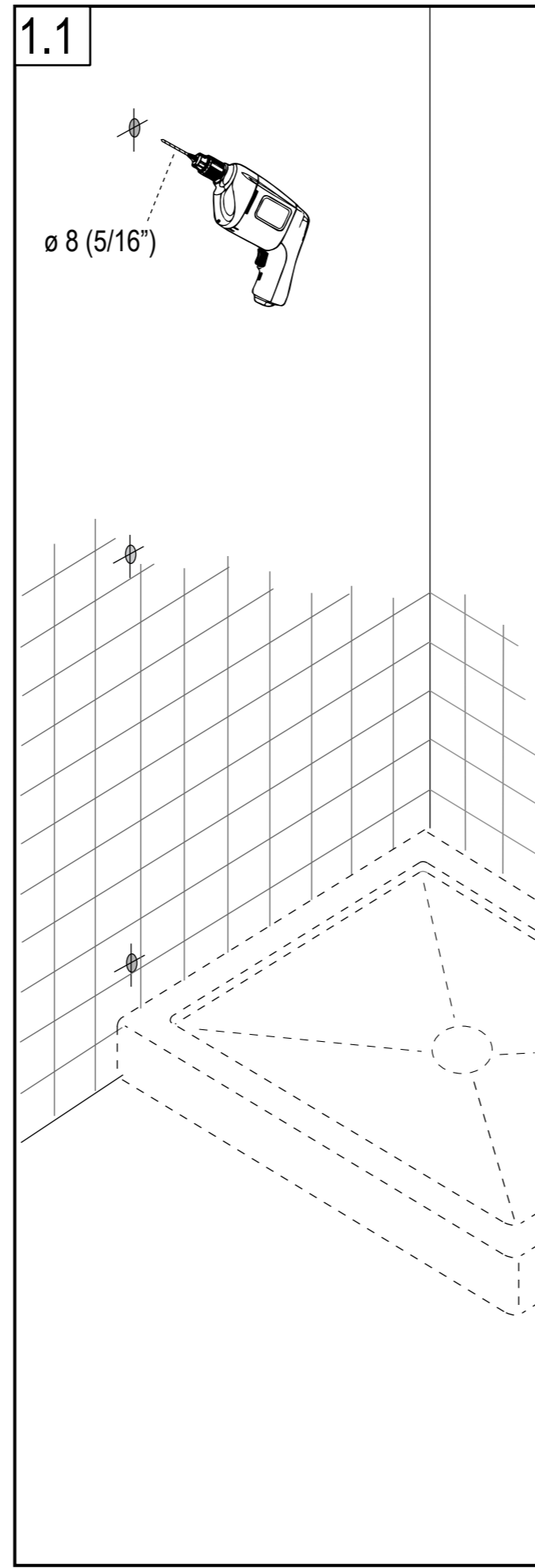
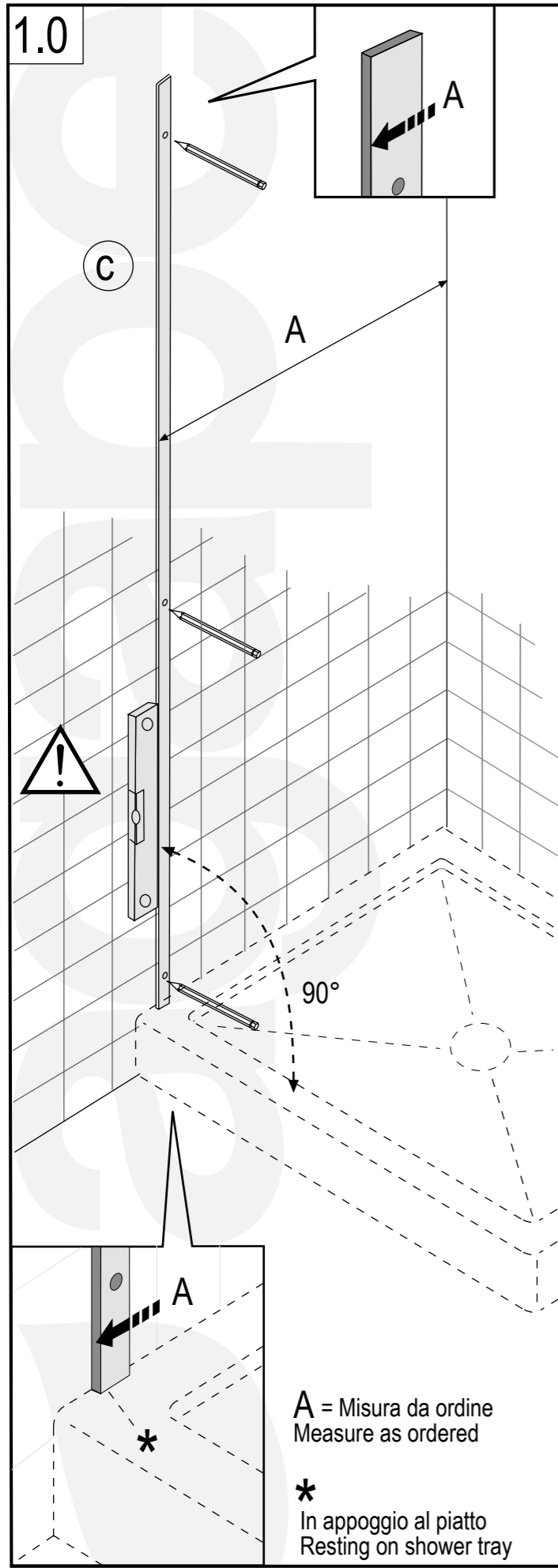

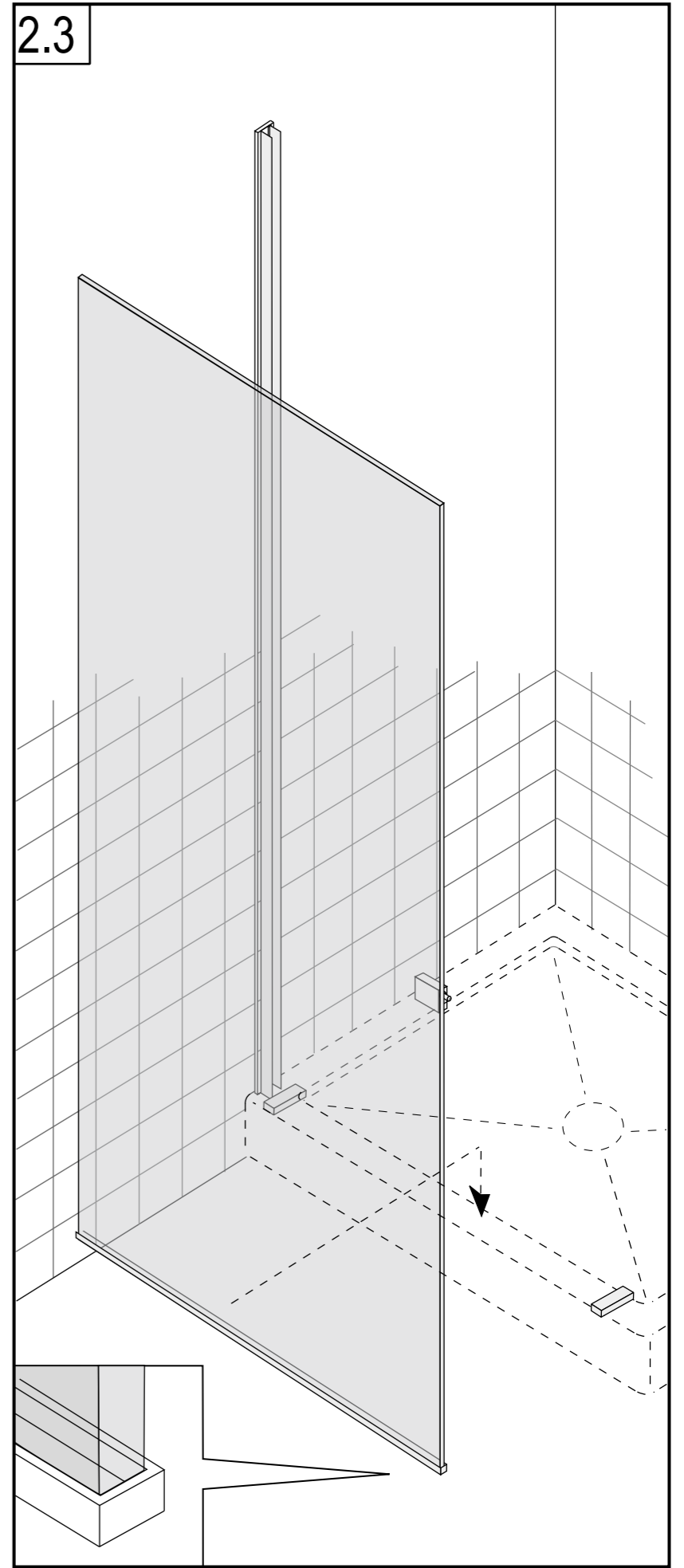
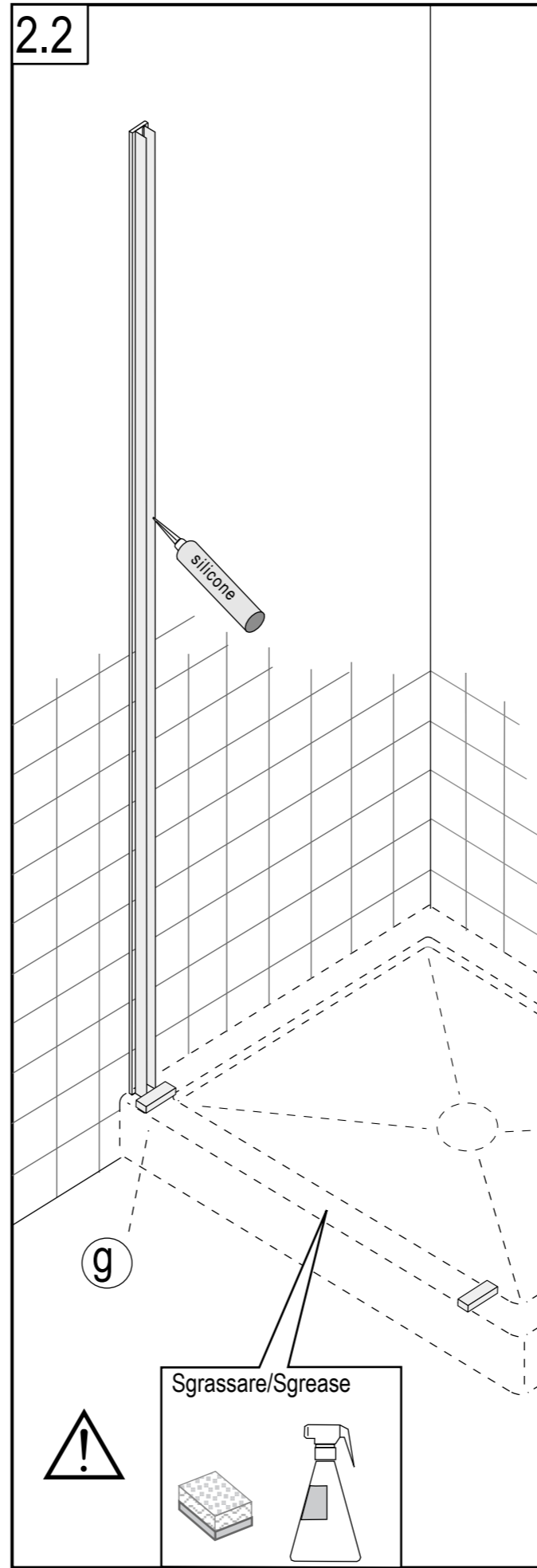
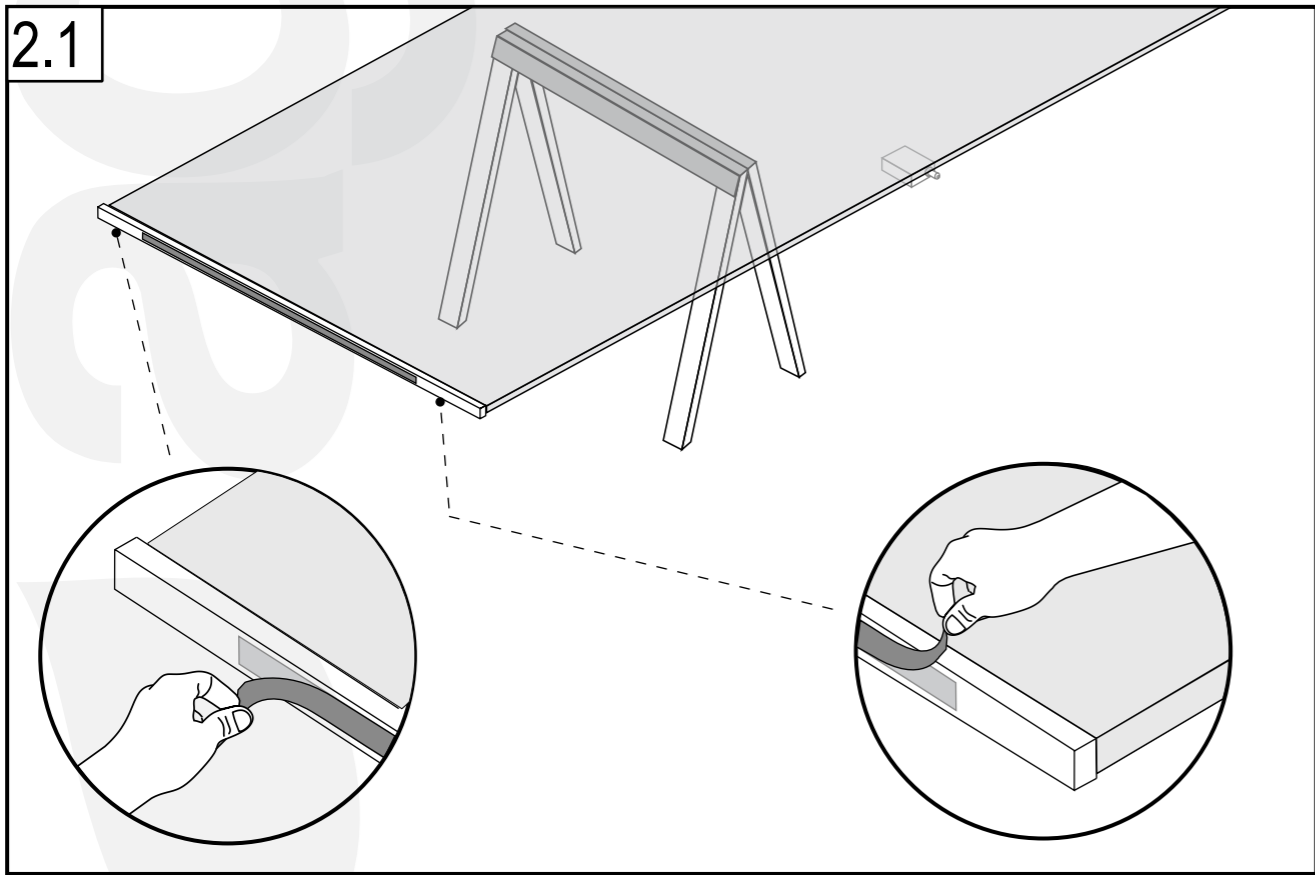
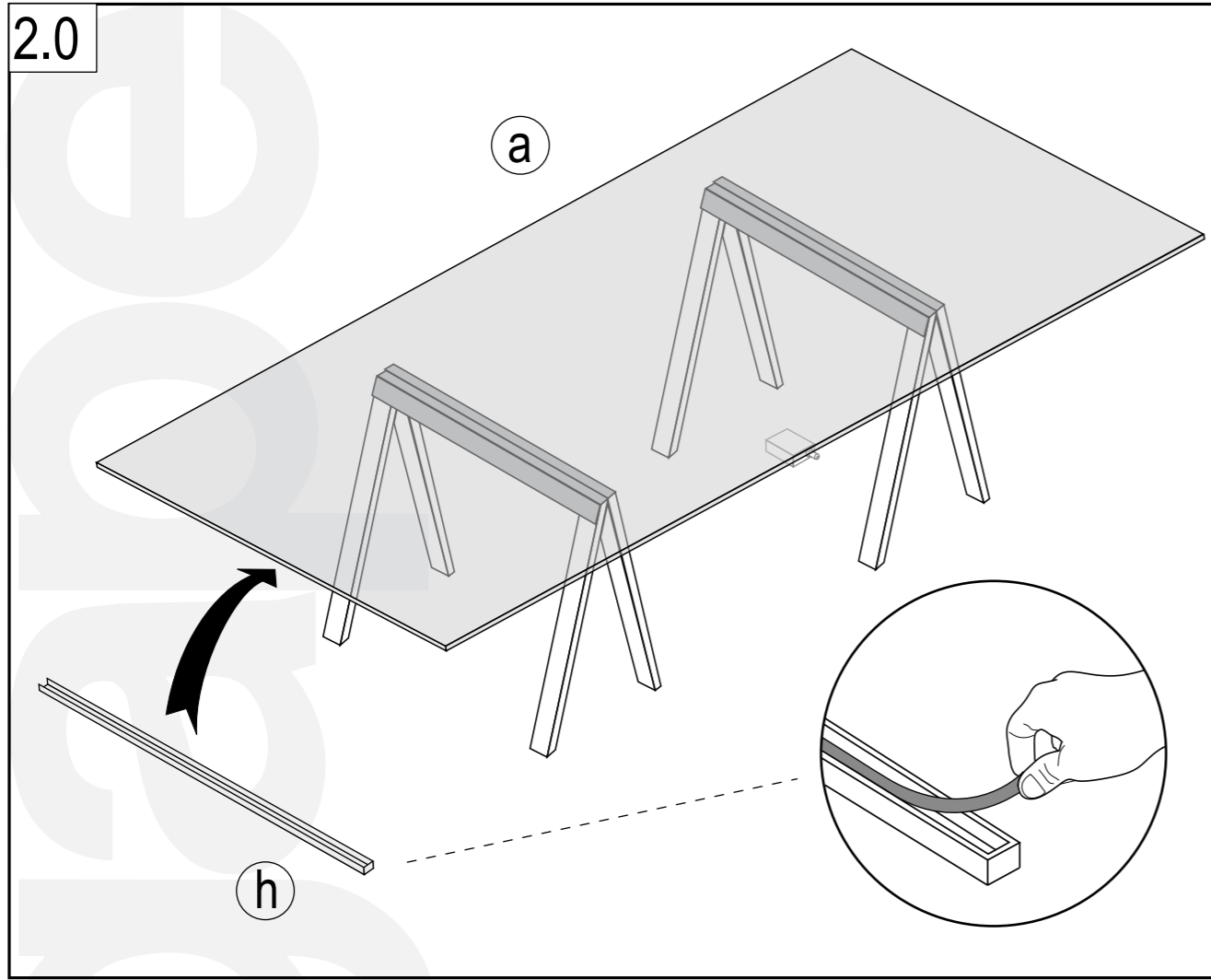

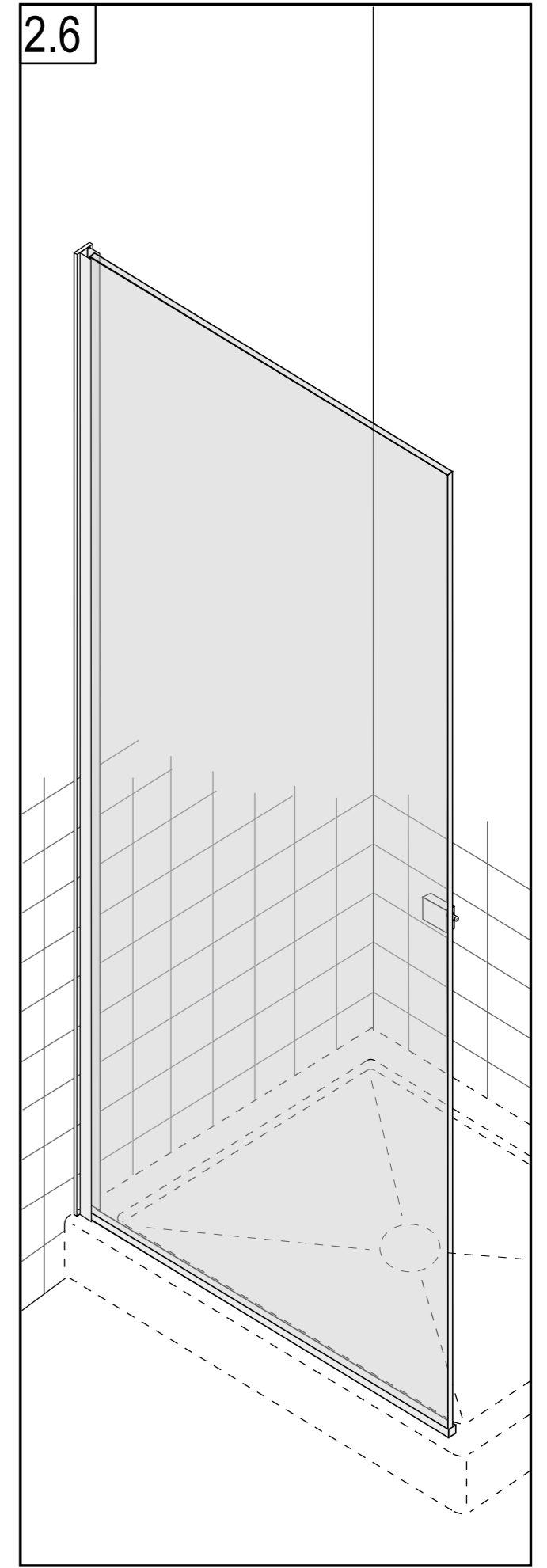
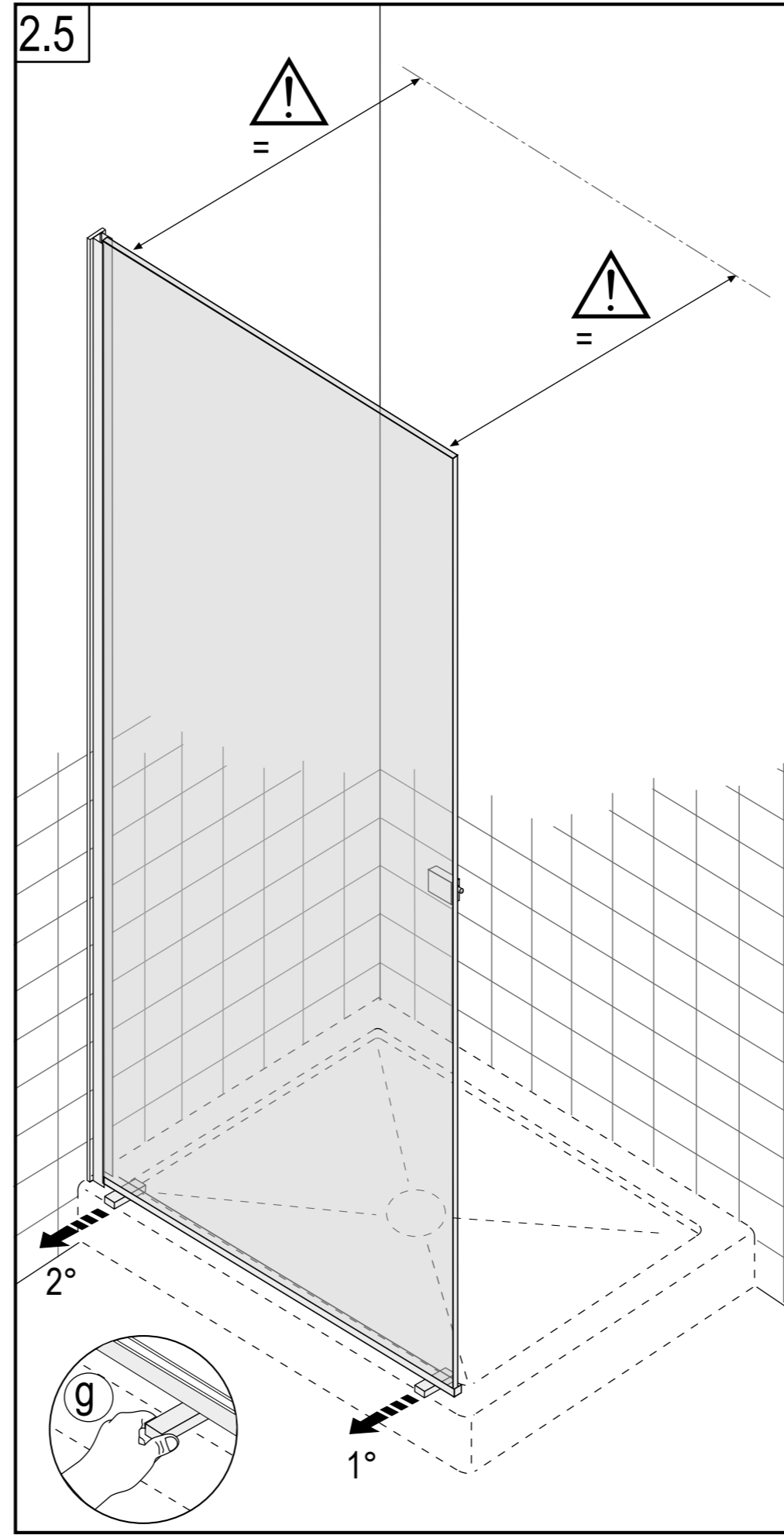
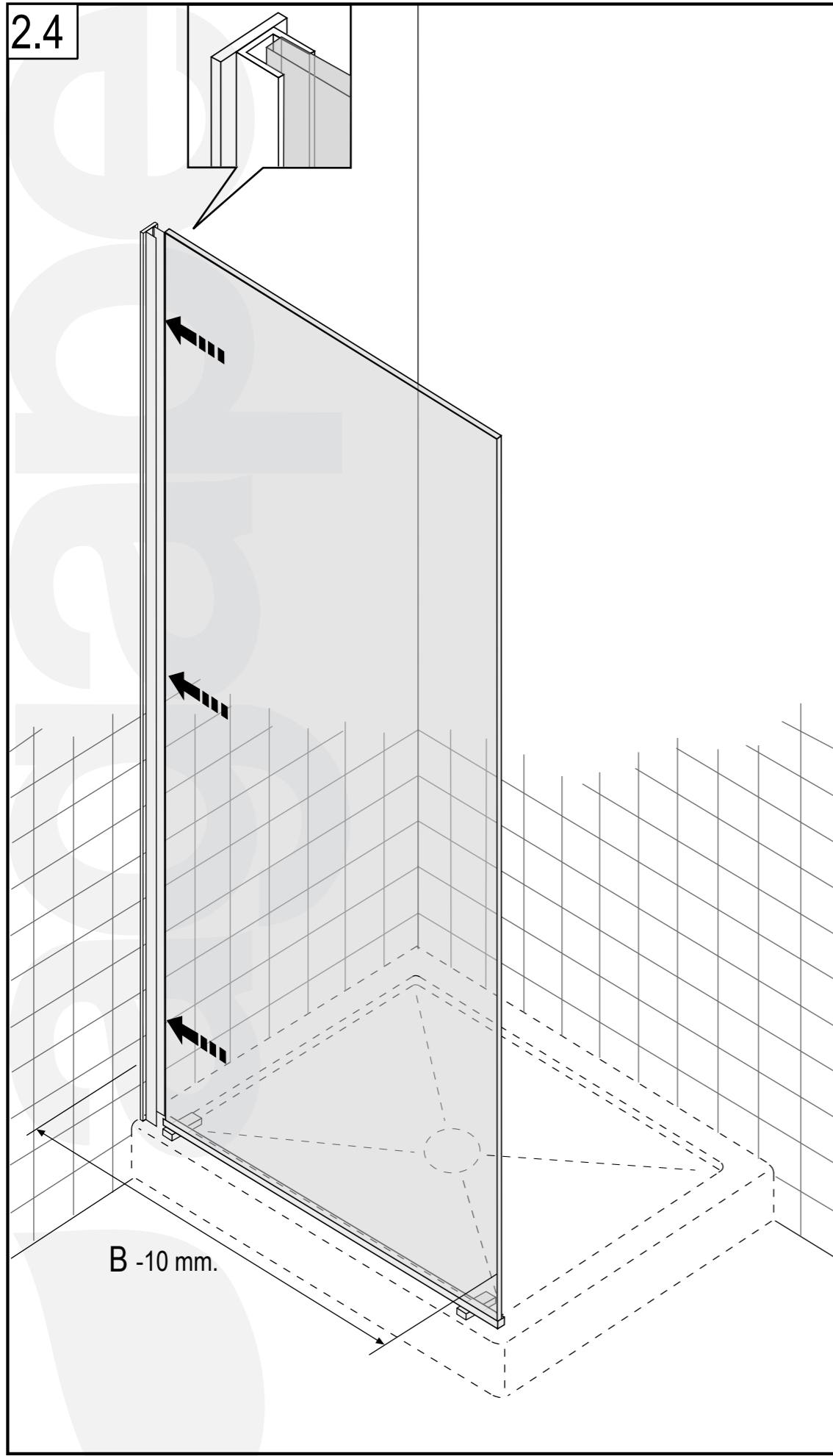

Anta / door - Esploso / pre - assembled

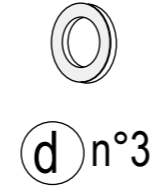
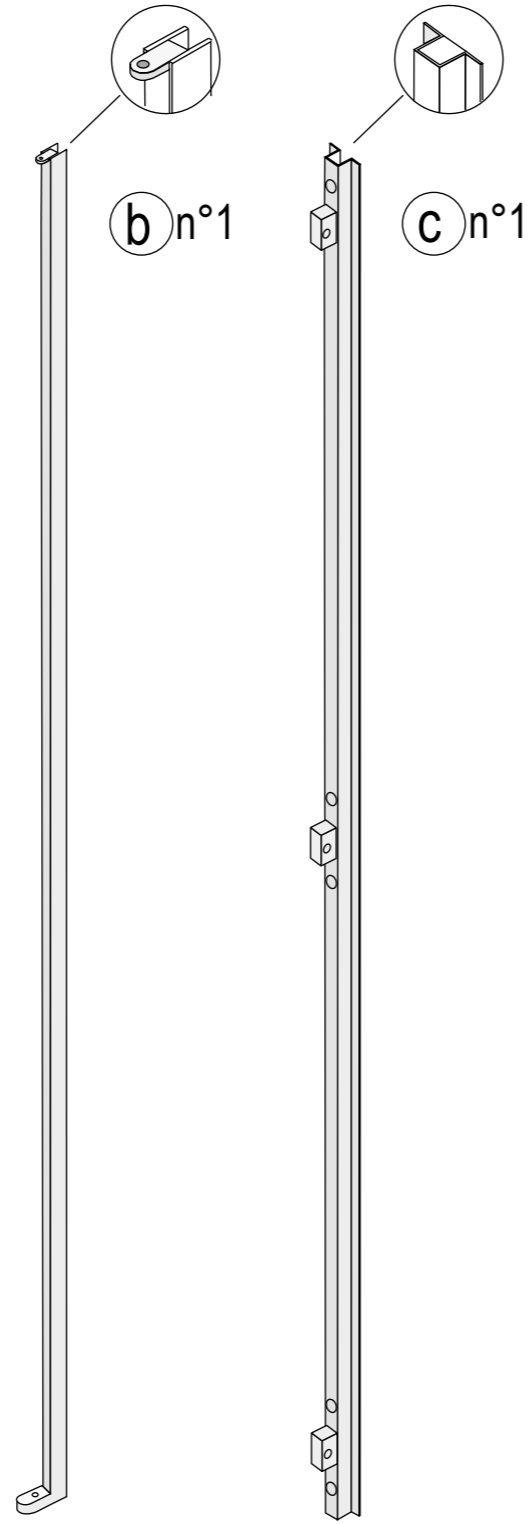

d n°3



e



f n°3



g n°3



h n°1

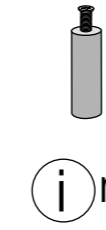

i n°1



l n°1

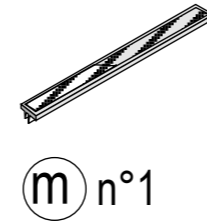

m n°1

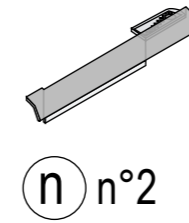

n n°2

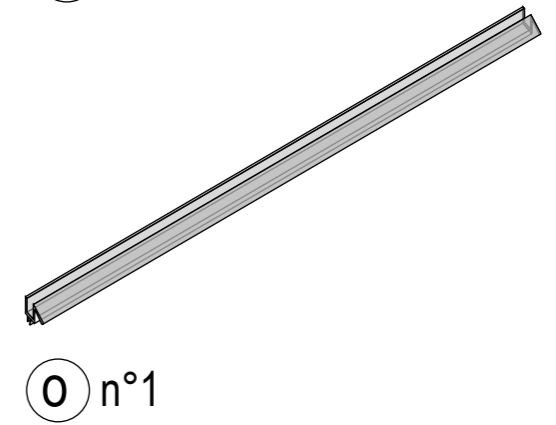

o n°1

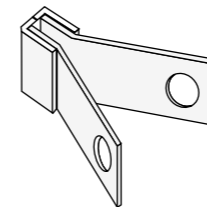

q n°1



r n°1

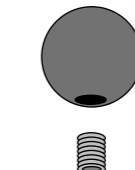

s n°1



t n°1



u n°1

